



# NORTH STREET COMMUNITY UPDATE MAY 2026

A community update on Arch & Bloom,  
a new neighbourhood for North Street.

**Berkeley**  
Designed for life

# NEW LIFE FOR NORTH STREET

At Berkeley, we believe regenerating brownfield land is the most sustainable way to solve the housing crisis, strengthen local communities and re-energise our towns and cities. At Arch & Bloom, North Street, we are proud to be delivering:



**485**

highly sustainable new homes



Over

**£1.2 MILLION**

in the pedestrianisation of North Street



**£4 MILLION**

invested in a new bus interchange



**3,500sqft**

new medical centre



**85**

New permanent jobs &

**400**

jobs during construction



**£250,000**

of public art investment



**2.2 Acres**

of new public realm

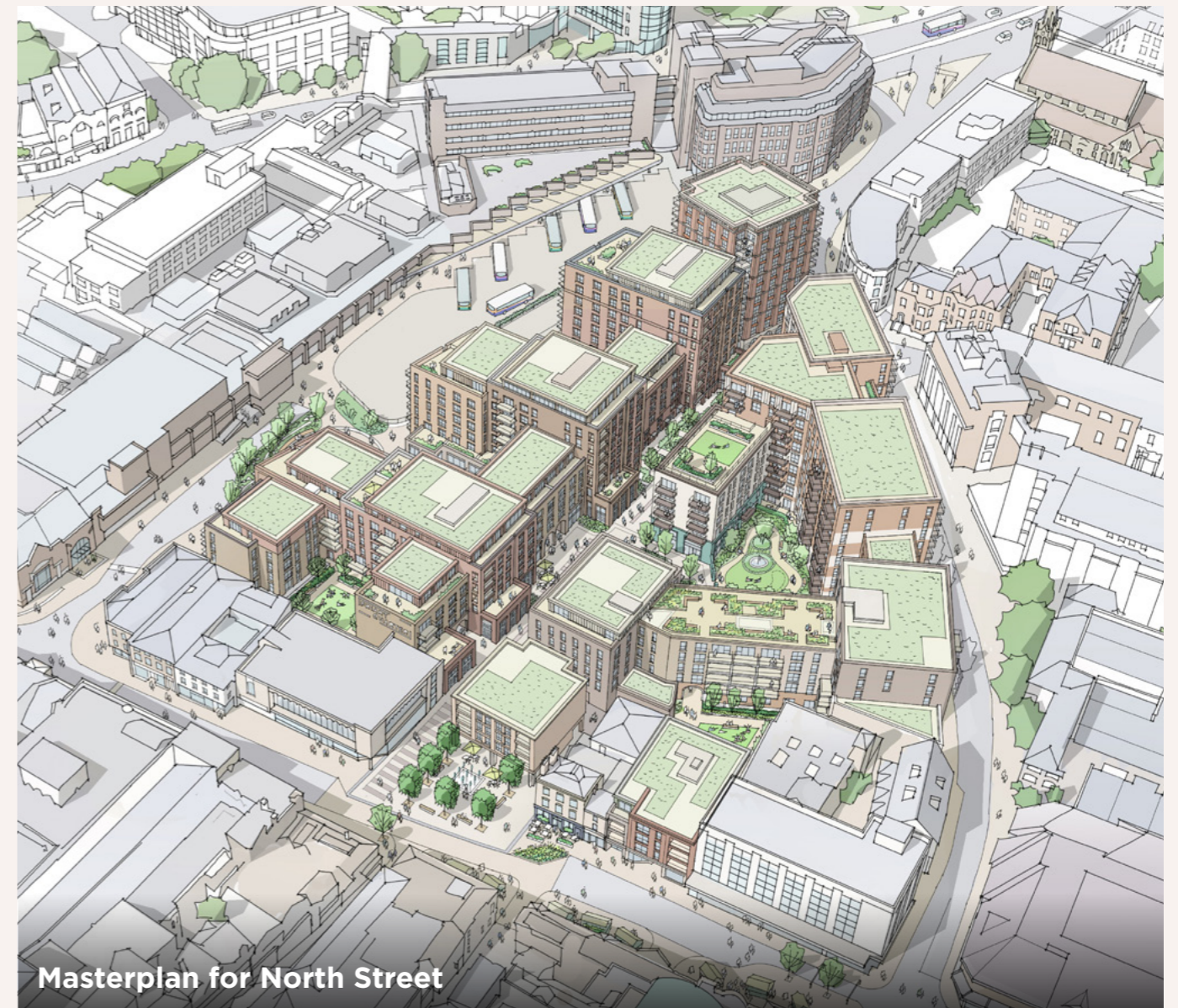

# WHAT'S HAPPENING ON SITE?

We are now gearing up for the sales launch, with the construction team preparing to finalise the Sales & Marketing Suite this summer. The suite has been designed with a balcony overlooking North Street, offering views of the vibrant bustle of Guildford's high street.

You will have noticed we have now completed the service diversion works to the project and are well underway with the improvements to the local networks of roads.



# MINIMISING WASTE, MAXIMISING IMPACT

In March 2026, the North Street development continued to demonstrate strong sustainability performance. Nearly 98% of construction waste was diverted from landfill, and responsible sourcing remained a priority, with FSC and PEFC timber compliance close to 100%. Water use has been carefully managed in line with project targets, while energy efficiency efforts continue, including a reduction of almost 30% in out of hours site energy use. This reflects our ongoing commitment to reducing environmental impact and working considerably alongside the local community.

# NEW WEBSITE LIVE

We are also excited to announce the official launch of the new website, [archandbloom.co.uk](http://archandbloom.co.uk). This has provided an early opportunity for those interested to explore the story behind the development and register for updates. By signing up, visitors can be among the first to hear about news, progress and upcoming events as Guildford's new urban landmark continues to evolve.

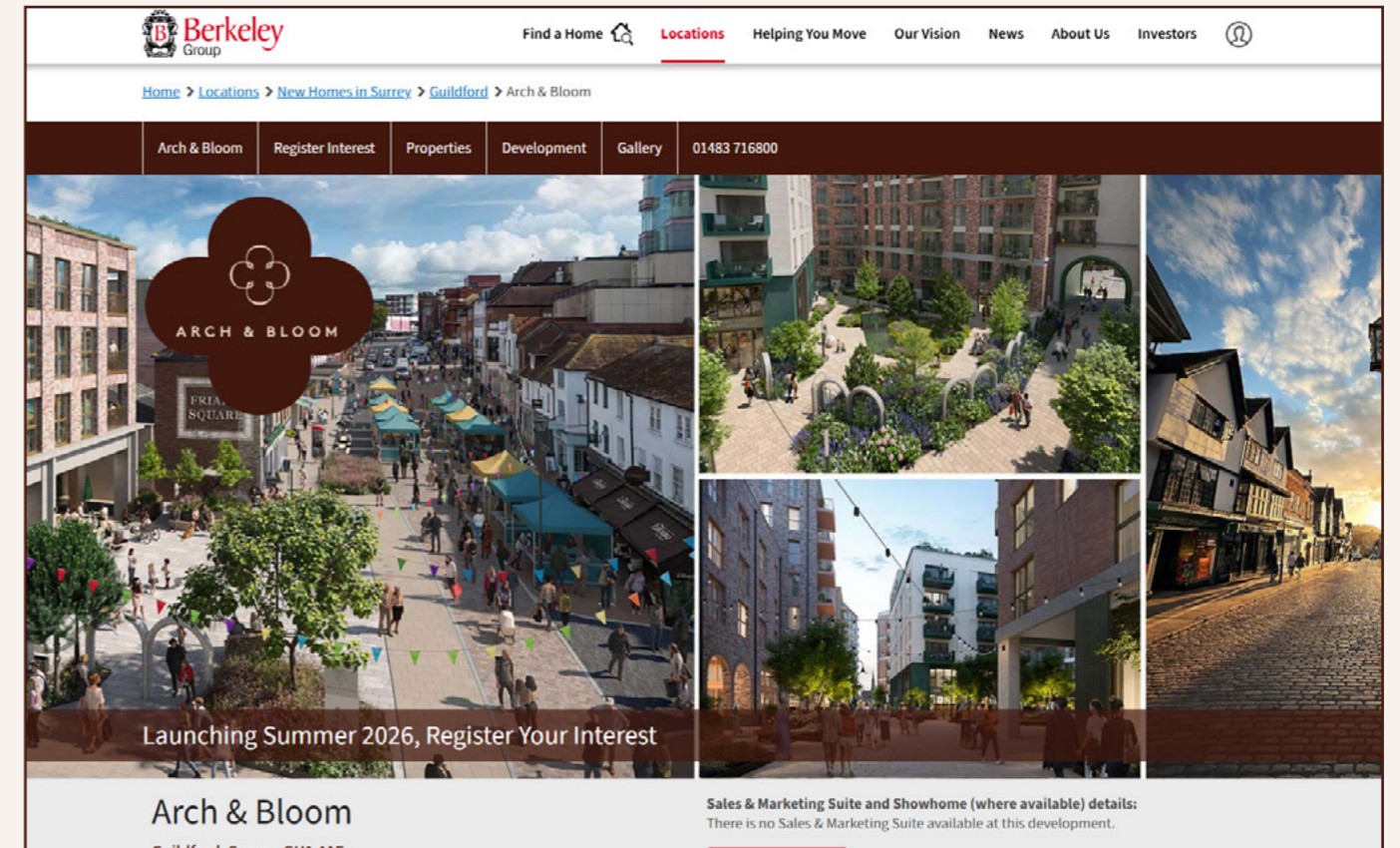

# COMMUNITY UPDATE MEETINGS

We are committed to keeping you informed as construction progresses and sharing updates on our ongoing community initiatives.

## Next Meeting

**Date:** Wednesday 15th April

**Time:** 6:00pm-7:15pm

**Location:** St. Saviour's Church, Woodbridge Road, Guildford, GU1 4QD

Please confirm your attendance by emailing Surjit Sonik on [surjit.sonik@berkeleygroup.co.uk](mailto:surjit.sonik@berkeleygroup.co.uk). If you cannot make it, but would like to hear from us in future, please let Surjit know and she will add you to our mailing list.

## GIVING BACK

Last Autumn we released our first round of community funding in North Street, worth a total of £6,000.

We were thrilled to support three amazing local organisations through this funding:

### STEP BY STEP - SUPPORTING YOUNG PEOPLE EXPERIENCING HOMELESSNESS

The funding supported 18 young people facing homelessness and other disadvantages by helping them:

- Overcome personal challenges
- Build confidence
- Develop essential life skills
- Move toward greater independence



### YVONNE ARNAUD THEATRE - DISCOVER THEATRE PROJECT

Enabled the theatre to run the Discover Theatre project for thirteen pupils from Year 7 with a range of special educational needs and disabilities at Gosden House School.

The workshops:

- Were tailored to meet each pupil's individual needs
- Encouraged creativity and expression
- Helped build confidence
- Supported pupils in forming positive social connections

### GUILDFORD IN BLOOM

Contributed to its 2025 campaign activities, including competitions, awards events, and community-focused environmental projects. This contribution ensured Guildford in Bloom could continue delivering high-impact initiatives that promote horticulture, sustainability, and biodiversity across the borough, strengthening its ability to engage residents, schools, and community groups in making Guildford a greener, more vibrant place.



## SUPPORTING LOCAL COMMUNITIES: FUNDING OPPORTUNITY ANNOUNCED

We have launched an additional £5,000 community funding pot, offering grants of up to £2,500 to support improvements in services and projects for community groups within one mile of Arch & Bloom, North Street.

The platform is completely free to use for non-profits of all shapes and sizes! Community groups can set up their profiles on the Action Funder platform at any time by heading to [Berkeley North Street Community Fund 2026](#).

Funding will be available to registered charities, social enterprises, faith centres, and schools, creating a valuable opportunity for organisations dedicated to making a positive impact.



**Sign up**  
**ActionFunder**

### MORE QUESTIONS?

There is also a [drop-in information session](#) once a month where you will be able to ask any questions related to the fund.

# WHAT'S HAPPENING IN THE COMMUNITY?

## TESTING OUR BALANCING SKILLS

This February, four enthusiastic members of the Arch & Bloom project team took part in the Guildford Annual Pancake Race, running a 50m relay through the high street while balancing their pancakes and completing flipping checkpoints along the route. We were delighted to take part, and a great time was had by all. The event helped raise funds for St. John's Food Bank Project.



## HELPING THE HIVE

We are pleased to support the Hive, an accessible space open to everyone of all ages, and they offer numerous activities and workshops for the whole family throughout the year.

Berkeley were delighted to be able to donate £300 towards their festive raffle and contribute chocolate selection boxes to a number of their young people.

# A VOICE FOR LOCAL BUSINESSES

In February, our Arch & Bloom team attended Experience Guildford's annual business forum, hosted by the wonderful Guildford Institute.

The event highlighted several initiatives aimed at improving safety, community engagement, and local support services in Guildford. This was a fantastic event which brought all communities together and provided much needed support and information to local businesses.



## INSPIRING THE NEXT GENERATION

The Arch & Bloom project is working closely with education providers and employment charities to deliver and coordinate an employment and skills programme that responds directly to local needs and opportunities.

Over the last year, the Arch & Bloom project has engaged with 918 individuals, hosted 4 employment and skills events, and supported 3 work placements.

These activities have helped create meaningful pathways into construction and regeneration, while strengthening links between the project and the local community.





# PHOTOGRAPHY COMPETITION

## YOUR GUILDFORD

We are running a photography competition to celebrate everything you love about your local area. The best entries will receive some great prizes.

### WIN!

£100 worth of vouchers to spend at your local favourite shops and restaurants.

### WHAT?

Simply capture an image that represents what you love most about the area. This could be anything, from a building to a park or a work of art or anything else that makes Guildford special to you.

### HOW?

Email your picture to **Surjit Sonik on [surjit.sonik@berkeleygroup.co.uk](mailto:surjit.sonik@berkeleygroup.co.uk) by 31st August**. Winners to be announced on 14th September.

The competition is open to all ages and abilities and pictures can be taken with any smartphone so no need for any professional camera.

## MEET THE NEIGHBOURS

In every edition of our newsletter, we shine a spotlight on the fantastic local charities and businesses that help make our community such a special place. It's our chance to introduce the people behind the work and celebrate the difference they make every day.

In this edition, we caught up with Katy, Corporate Partnerships Fundraiser from the charity Step By Step:

### Can you tell us about Step by Step?

Step by Step is a local charity supporting young people aged 11–25 across Surrey and neighbouring areas, helping to prevent youth homelessness and empowering young people to build the skills and confidence needed for independent lives.

We work with those who are homeless or at risk, offering tailored support with safe accommodation, education, employment, and practical life skills.

In 2025/26, local funding enabled us to provide over £4,000 in direct financial assistance to remove barriers such as rent deposits, travel costs, work clothing, and specialist course equipment, while a generous £2,000 donation from Berkeley supported our Opportunities Fund for young people in Guildford. These targeted interventions, combined with ongoing support, make a life-changing difference - helping young people move from crisis toward stability, opportunity, and a more secure future

### Why is this work so important to you?

This work is so important to me because no young person should have to face the uncertainty of where they'll sleep each night. Everyone deserves a safe place to live, along with the support and guidance to build a stable future. Step by Step helps young people move beyond crisis, giving them the practical help, confidence, and skills they need to live independently and make positive choices for themselves. Being able to provide this kind of support can truly change lives.

### How can people find out more about Step by Step?

People can learn more about Step by Step by visiting their website at [www.stepbystep.org.uk](http://www.stepbystep.org.uk) or by emailing me at [katy.day-jones@stepbystep.org.uk](mailto:katy.day-jones@stepbystep.org.uk) to get involved or ask questions.





## ENVIRONMENTAL MONITORING

Noise, vibration and dust levels will be controlled throughout the duration of all works to ensure that our impact on the local environment minimised.

## SITE WORKING HOURS

08:00 to 18:00 Monday to Friday 08:00 to 13:00 on Saturdays excluding Bank Holidays Any out of hours working that can be heard from outside of the site boundary, will only be permitted following the necessary approvals from Guildford Borough Council Council. Security remain on site everyday should you have any concerns.

---

### FOR ANY COMMUNITY RELATED QUESTIONS:



**Surjit Sonik**  
Community Engagement Manager  
[Surjit.Sonik@berkeleygroup.co.uk](mailto:Surjit.Sonik@berkeleygroup.co.uk)

### FOR ANY QUESTIONS ON EMPLOYMENT & SKILLS RELATED QUESTIONS:



**Hannah Mu**  
Talent and Social Value Manager  
[Hannah.Mu@berkeleygroup.co.uk](mailto:Hannah.Mu@berkeleygroup.co.uk)



## CONSIDERATE CONSTRUCTION

We are signed up to the Considerate Constructors Scheme, a national initiative which monitors construction.